

Model Year 2007

Feel the Energy!



***Super Light - Wide body construction
I-Max frame by Zieman
X-tra light ramp door
Extra-thick floor decking
Full walk-on roof***

NRG

220 FB

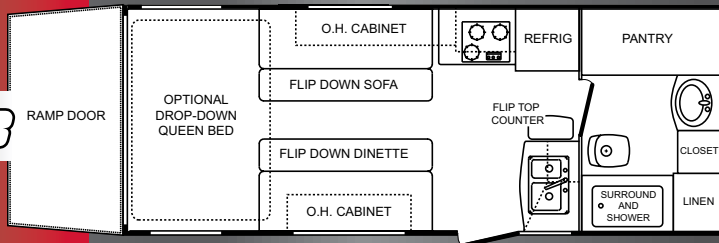

230 FS

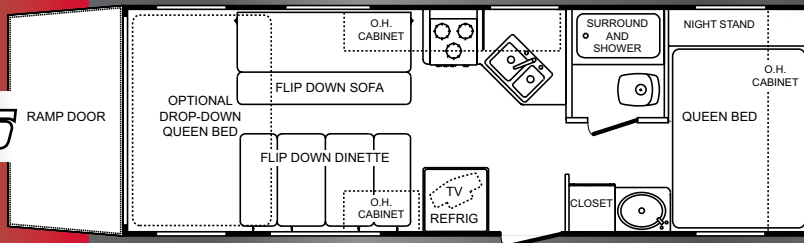

260 FS

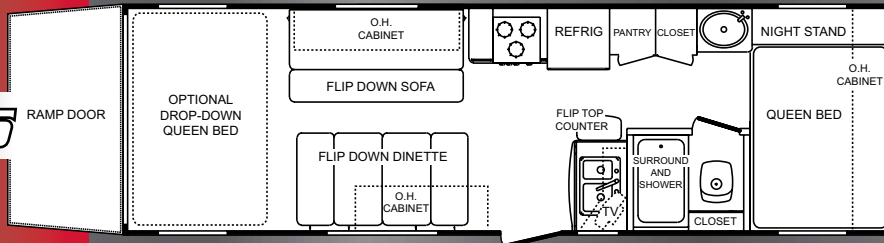

KEYSTONE PERFORMANCE

a product by



2642 Hackberry Dr.

Goshen, IN 46526

574.535.2100

www.keystone-nrg.com



Specifications

ITEM	220FB	230 FS	260 FS
Shipping Weight	6140	6380	6880
Carrying Capacity	3910	3670	4070
Hitch	1040	1085	1240
Exterior Length	25'	27' 8"	31' 0"
Exterior Width	8'	8'	8'
Ext Height - Top of A/C	11' 5"	11' 5"	11' 5"
Fresh Water Capacity	100	100	100
Waste Water Capacity	28	28	28
Grey Water Capacity	32	32	32
LPG Capacity (lb)	60	60	60
Tire Size	225/75R15D	225/75R15D	225/75R15D
Rim Size	15 x 6	15 x 6	15 x 6

Popular Options

- Chrome Wheels
- Screen Wall
- Generator
- Dual Electric Beds

NRG

STANDARD

BUILD

FEATURES

- Construction exceeds RVIA building codes
- Microwave oven
- Awning
- X-tra large 22" oven
- 3 burner range w/ vent fan and light
- Double door refrigerator / freezer
- Large 60/40 deep bowl sink w/ high rise faucet
- 6 gallon quick recovery water heater w/ direct spark ignition
- Detachable face CD player
- Thermostat controlled 20K Furnace
- Large thermostat controlled A/C
- Monitor panel w/ Gray, Black, Fresh, and Battery Condition
- Mini blinds w/ hard valances
- TV antenna with booster
- Cable TV hook up
- Bedroom cable hook up
- Exterior shower
- 12v on demand water pump
- 110 / 12v electrical system
- 50 amp converter / battery charger
- Deep Tinted safety glass windows
- Removable self edged living-room carpet w/ marine backing
- X-tra large door side bay window
- Formica counter tops
- Caulked back splashes and counter tops vs. bulb seals
- Mirrored vanity
- Large overhead cabinets
- Large TV compartments
- Lights under O/H cabinets
- Solid wood cabinetry
- Contemporary, Euro styled interiors
- Residential metal drawer hardware
- Separate light switch in bathroom
- Sofa and Dinette skirting
- Aerodynamic front profile
- X-tra high front diamond plate
- Dual 5200# axles w/ 4 - 12" electric brakes
- Wide track axle system
- Ultra lube axles
- Off road leaf spring suspension
- 2 windows in cargo area
- X-tra large front storage compartment
- Exterior speakers
- Front, Rear, DS, and ODS Outside Lights
- Dual battery rack
- Dual LP Tanks
- 1 - Piece Floor decking
- 9 - recessed "D-Ring" Tie Downs - no exposed eye bolts
- 1 - Piece Rubber Roof
- Residential Truss style roof construction
- Roof Ladder
- Radius Baggage Doors
- Spare tire
- "Beaver Tail" for Lower ramp angle
- Generator prep fuel tank and pump station
- Fully welded outriggers
- Double entry step
- Radius bottom skirt wrap
- ABS fender skirts
- Indoor / Outdoor Table
- Mirrored wardrobe
- Stabilizer Jacks

NRG PRO PACKAGE

- Wide Body Construction
- Zieman I-MAX Chassis* (42% stronger than c-channel, 144% stronger than box tube)
- Zieman Z-CROSS Cross members*
- Full Width Outriggers with outer edge weight distribution stringer
- 3/4" Floor Decking (Compare to others at 5/8")
- 9 - Recessed "D-Ring" Tie Down
- Space Age Radiant Foil Floor Insulation* (Retains and Reflects 97% of all Cold & Heat)
- Darco Weather Proof Underbelly
- Ram Air Cargo Ventilation System
- X-tra Light Ramp Door w/ 2,500# Rating (Springs are on the hinges-includes grease zerks)
- 100 gallon fresh water tank
- Full walk-on roof
- Black Tank Flush
- Satellite Ready
- Porcelain Foot Flush Toilets
- Diamond Plate in Cargo Area
- Automatic Transfer Switch For Generator
- Carbon Monoxide Detector
- LP Leak Detector
- Fire Extinguisher

* = NRG Exclusive

Product information is as accurate as possible as of the date of publication of this brochure. Features, floor plans, and specifications are subject to change without notice. Please also consult Keystone's web site at keystone-nrg.com for more current product information and specifications. CAUTION: Owners of Keystone recreational vehicles are solely responsible for the selection and proper use of tow vehicles. All customers should consult with a motor vehicle manufacturer or their dealer concerning the purchase and use of suitable tow vehicles for Keystone products. Keystone disclaims any liability or damages suffered as a result of the selection, operation, use or misuse of a tow vehicle. KEYSTONE'S LIMITED WARRANTY DOES NOT COVER DAMAGE TO THE RECREATIONAL VEHICLE OR THE TOW VEHICLE AS A RESULT OF THE SELECTION, OPERATION, USE OR MISUSE OF THE TOW VEHICLE. 05/2006